

UNFINISHED SHAFT ENDS

Screw shaft diameter $\phi 10$, Lead 4 (M nut)

(Unit : mm)

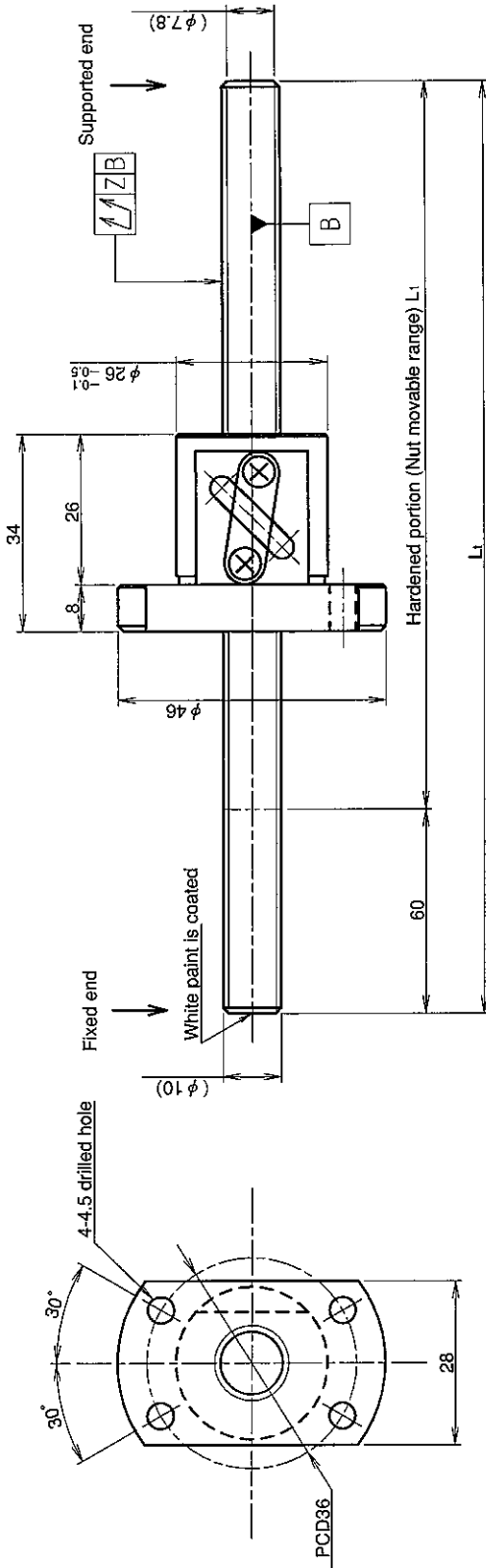

Ball screw specifications

Screw shaft dia.	10	Basic dynamic load rating	2300N
Lead	4	Basic static load rating	4800N
Thread direction	Right-hand	Lubricant	Alvania Grease No.2
Number of starts	2.5turn 1circuli	Surface treatment	Phosphate coating
Ball diameter	2.3812		

Table of optional specifications for each model

Additional machining of shaft end	Surface treatment (Note 1)	Difference of grease	Direction of nut
○	○	○	○

(Note 1) The above-mentioned surface treatment is LD treatment (coating thickness : 1 to 2 μ m).

Model No.	Axial clearance	L ₁	Z	L _t	Wiper
GY1004DS-HANR-0400A	~0.050	340	0.150	400	Without
GY1004DS-HANR-0600A		540	0.240	600	Without

Notation of standard rolled ball screw

- Standard length shaft without end machining (Matched screw shaft and nut)
GY1004DS-HANR-□□□□□□□□□□-CAY
- Nut only without screw shaft
GY1004DS-HANR
- Screw shaft only without end machining
GY1004ZZ-ZZZZ-□□□□□□□□□□

- With end machining specified on your drawing (Matched screw shaft and nut)
GY1004DS-HANR-□□□□□□□□□□X□□□□□□□□□□-CAY
- With end machining specified on your drawing (Screw shaft only)
GY1004ZZ-ZZZZ-□□□□□□□□□□Y□□□□□□□□□□-CAY

Overall length Thread length

