

**UNFINISHED SHAFT ENDS**

**Screw shaft diameter  $\phi$  15, Lead 5 (K nut)**

(Unit : mm)

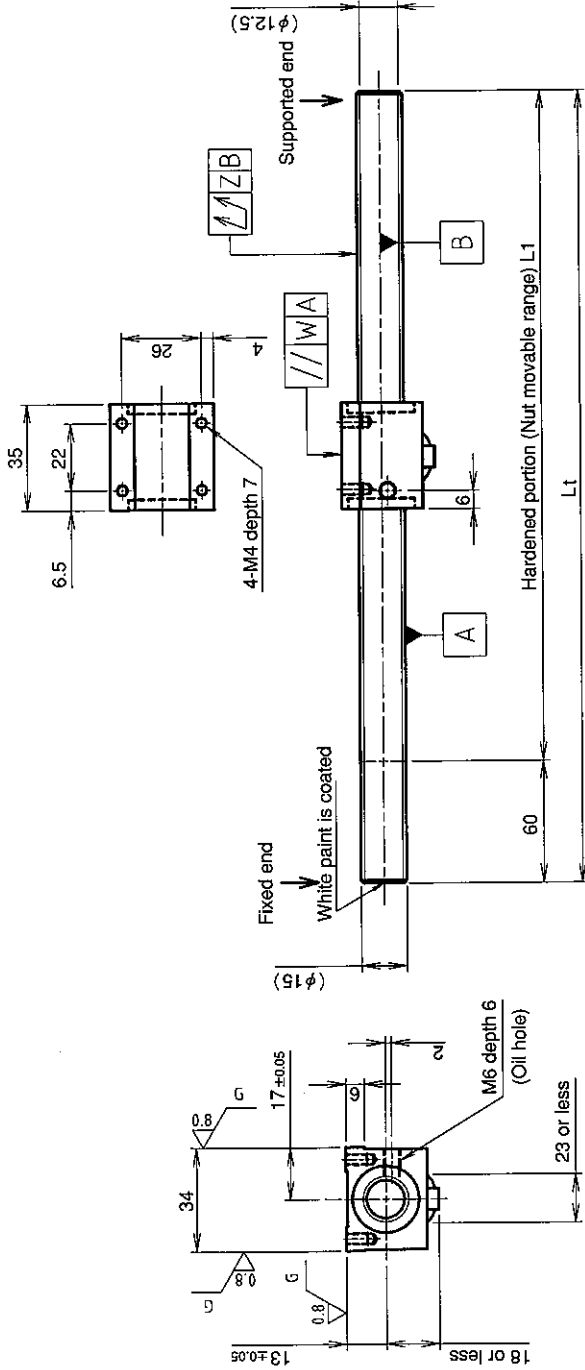

**Ball screw specifications**

Screw shaft dia.	15	Basic dynamic load rating	5100N
Lead	5	Basic static load rating	10500N
Thread direction	Right-hand	Lubricant	Alvania Grease No.2
Number of circuits	2.5 (turn 1 circuit)	Surface treatment	Phosphate coating (Nut only)
Ball diameter	3.175		

**Table of optional specifications for each model**

Additional machining of shaft end	Surface treatment (Note 1)	Difference of grease	Direction of nut removal	Wiper
○	○	○	○	○

(Note 1) The above-mentioned surface treatment is LD treatment (coating thickness : 1 to 2  $\mu$  m).

Model No.	Axial clearance	L <sub>t</sub>	L <sub>1</sub>	W	Z	Wiper
GW1505DS-NKLR-0600A	~0.030	600	540	0.017	0.070	Lip seal
GW1505DS-NKLR-1200A		1200	1140		0.170	

**Notation of standard rolled ball screw**

- Standard length shaft without end machining  
GW1505DS-NKLR-□□□□A
- With end machining specified on your drawing  
GW1505DS-NKLR-□□□□X□□□□-C7Y

Overall length    Thread length

**KURODA** Standard Rolled Ball Screw : GW Series (Accuracy grade C7)

**SHAFT END FINISH ORDERING SHEET**

Screw shaft diameter  $\phi$  15, Lead 5 (K nut)

(Unit : mm)

GW1505DS-NKLR-    X    -C7Y

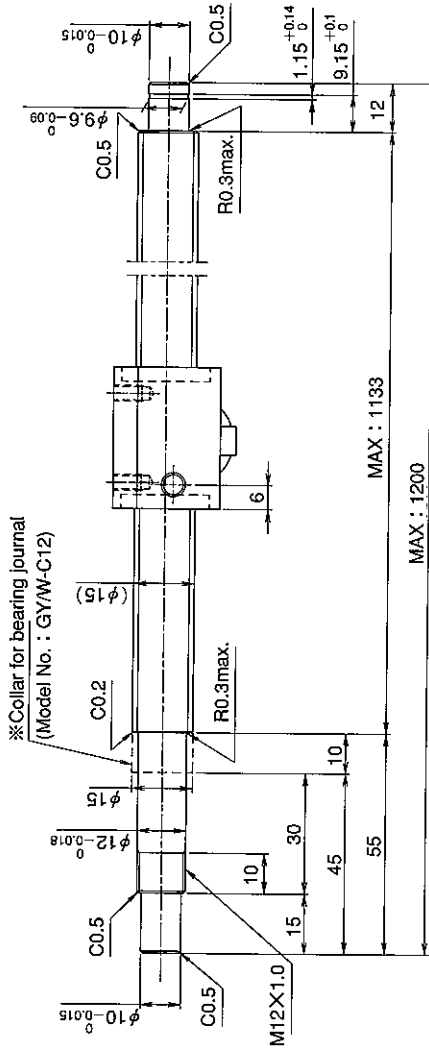
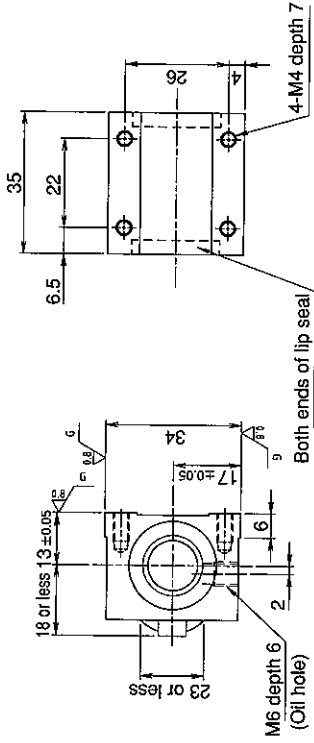

※ Please place an order for collar separately.

Applicable Support Unit

Direct mount : BUJK-12A (Fixed end unit+Supported end unit) Refer to Page.405

Circle flange : BUM-12 (Fixed end unit+Supported end bearing) Refer to Page.412

Company Name		
Telephone		Name of Person in Charge
Company Address		

Refer to page 24 for NOTATION OF MODEL NUMBER.